

REV.	DESCRIPTION	DCR	BY	DATE	APPROVED

Item #1

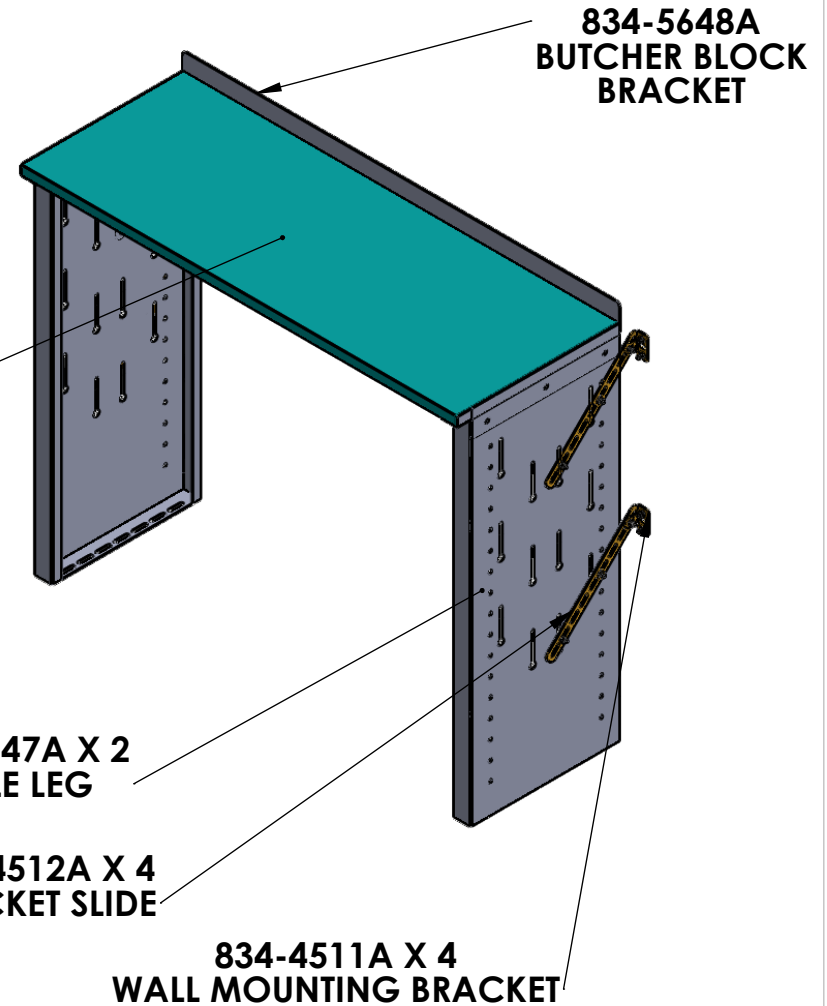
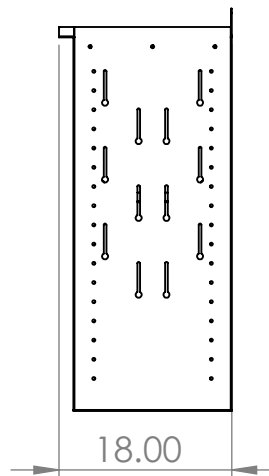
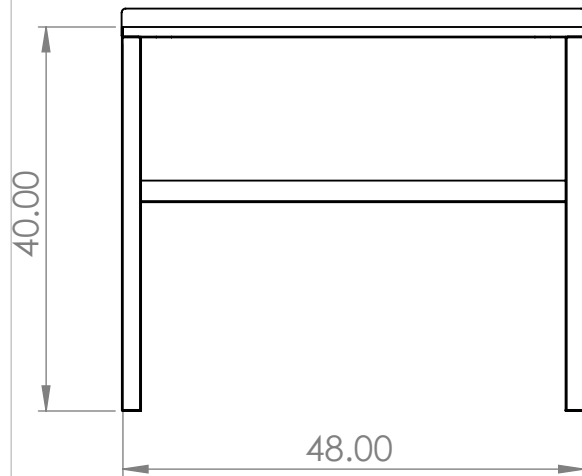
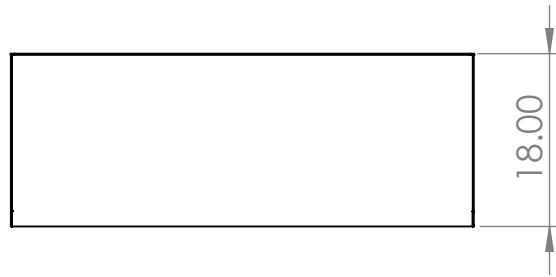

- FEATURE:**
- FINISHED WOOD TOP WORKING SURFACE
 - CONSTRUCTED FROM 0.09" ALUMINUM

	NAME	DATE	 ELECTRONICS CO., LTD.	DANDR-ANSI-A	SIZE
DRAWN	NT	25JUL2024		REV2	A
				APRIL 1, 2009	
CHECKED	AD	25JUL2024	Path: M:\MECH_DESIGN\Nick Proto\OPP Tender Design Req 8274 V2\table\ File: 934-1013A Date: August 1, 2024 10:31:02 AM		
THE INFORMATION CONTAINED WITHIN THIS DRAWING IS PROPRIETARY AND CONFIDENTIAL. AND IS THE SOLE PROPERTY OF DandR ELECTRONICS CO. LTD. IT MAY NOT BE REPRODUCED AT WHOLE OR IN PART WITHOUT THE WRITTEN PERMISSION OF DandR ELECTRONICS CO. LTD.			DESCRIPTION: WORKBENCH WITH WOOD TOP (18"D X 48"W X 16"H)		
FINISH			MFG. NO.	CATALOG. NO.	
			934-1013A	XXX	
			USED ON:		SHEET 1 OF 1
			MATERIAL		REV.
			XXga CRS		0